

E1.S SSD Mobile Rack for 5.25" Bay

Applicable Models

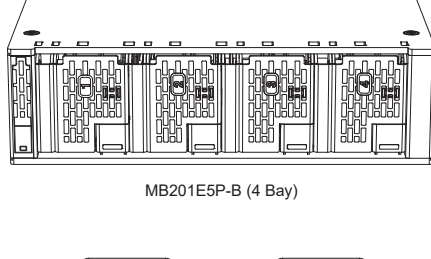

MB201E5P-B (4 Bay)

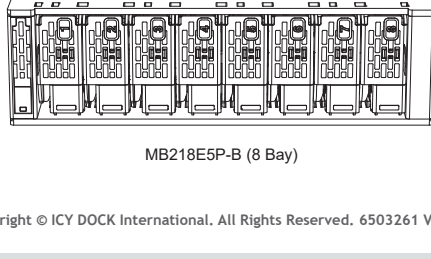

MB218E5P-B (8 Bay)

Copyright © ICY DOCK International. All Rights Reserved. 6503261 VER 2.0



Cremax Europe GmbH
Email: support@icydock.com
Weidenweg 21H, 47059 Duisburg, Germany



Beyond Technologies UK Ltd
Email: info@beyondtech.co.uk
Unit B6, Halesfield 11, Telford, Shropshire, TF7 4PH, U.K.

1

Package Contents • Packungsinhalt • Contenu • Contenido del paquete

• 包装について • 包装説明 • 包装说明



MB201E5P-B mobile rack



MB218E5P-B mobile rack



User manual

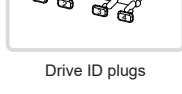

Drive ID plugs



10 x M3*6 screws for MB201E5P-B/MB218E5P-B installation (2 x screws for spare parts)

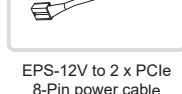

EPS-12V to 2 x PCIe 8-Pin power cable (MB218E5P-B only)

Note: Please use the included screws to secure the MB201E5P-B/MB218E5P-B.

2

Device Information • Geräteinformationen • Informations dispositif

• Información del dispositivo • 本体説明 • 機體説明 • 机体说明

Top View

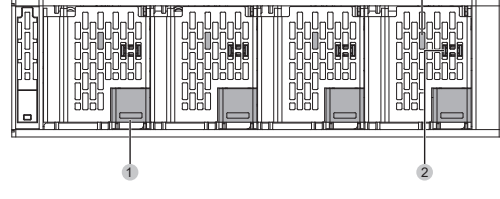

(MB201E5P-B)

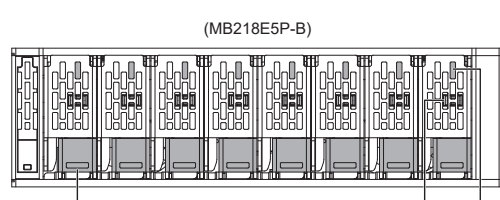

(MB218E5P-B)

- 1 Drive tray ejection button
- 2 LED status indicator : solid green for power, flashing green for SSD activity
- 3 Slot for drive ID plug

Rear View

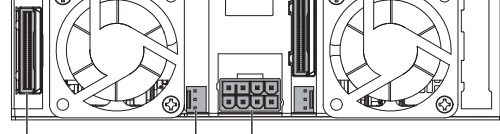

(MB201E5P-B)

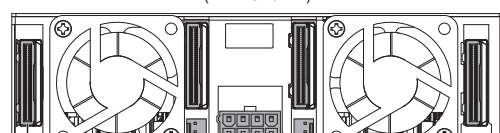

(MB218E5P-B)

- 1 MCIO 8i connector (SFF-TA-1016)
- 2 3-Pin fan header port
- 3 PCIe 8-Pin power
- 4 EPS-12V power

Tray View

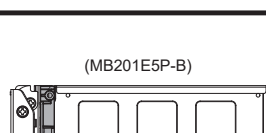

(MB201E5P-B)

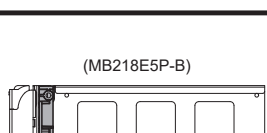

(MB218E5P-B)

E1.S SSD mounting fastener

3

Installation Guide • Installationsanleitung • Guide d'Installation • Guía de instalación

• 製品の組み込み手順について • 操作手順 • 操作步驟

Note: The E1.S SSD installation procedure is identical for both models. The example below uses the MB218E5P-B.

3-1

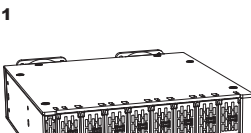

Press the drive tray ejection button located beneath the tray opening to unlock the drive tray.

3-2

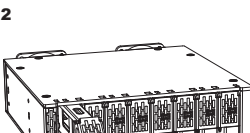

Grasp the drive tray release handle and pull the tray out of the mobile rack.

E1.S SSD Installation

3-3

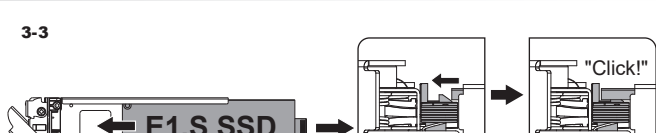

Insert the E1.S SSD from the rear of the tray and slide it forward toward the E1.S SSD mounting fastener located at the front. Push the SSD firmly into the fastener until you hear a "click", confirming that the SSD is securely locked in place.

E1.S SSD Removal

3-4



To remove the E1.S SSD, press both sides of the E1.S SSD mounting fastener inward to release it. The SSD will disengage, allowing you to slide it out from the rear of the tray.

3-5

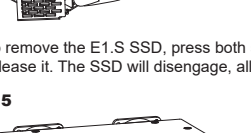

3-6

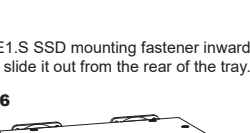

4

Device Installation • Installation eines Gerätes • Installation du dispositif

• Instalación del dispositivo • デバイス取付手順 • 装置安裝步驟 • 设备安裝步驟

(MB201E5P-B)



1. Insert the mobile rack into a standard 5.25" drive bay and secure it using the included M3*6 screws.

2. Connect the PCIe 8-Pin power cable and the MCIO cable to complete the installation.

(MB218E5P-B)

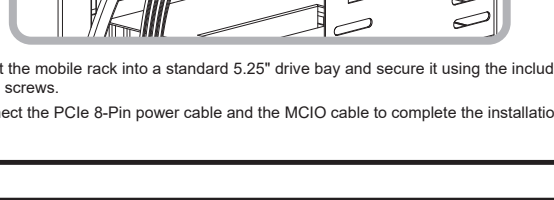

1. Insert the mobile rack into a standard 5.25" drive bay and secure it using the included M3*6 screws.

2. Connect the EPS-12V power cable and the MCIO cable to complete the installation.

Warning:

- 1. Due to the compact connector spacing, it is recommended to use a pen or screwdriver to help disconnect the cables when needed.
- 2. Do not connect a PCIe 8-Pin power plug to the EPS-12V power port on the MB218E5P-B.
- 3. If your power supply does not have an EPS-12V port to a PCIe 8-Pin power port, then connect the PCIe 8-Pin power plug from the power supply.

Warranty

icydock.com/warranty



Check coverage and terms

Product Resources

Specs - Data Sheet - FAQ



MB201E5P-B



MB218E5P-B

ICY DOCK reserves the right to change product specifications, components, or accessories without prior notice