

Copyright © ICY DOCK International. All Rights Reserved. 650317 VER 1.0



Cremax Europe GmbH
Email: support@icydock.com
Weidenweg 21H, 47059 Duisburg, Germany



Beyond Technologies UK Ltd
Email: info@beyondtech.co.uk
Unit B6, Halesfield 11, Telford, Shropshire, TF7 4PH, U.K.

1

Package Contents • Packungsinhalt • Contenu • Contenido del paquete

• 包装について • 包装説明 • 包装说明

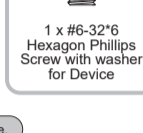
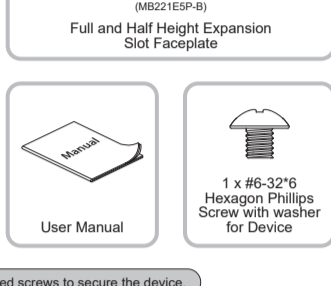
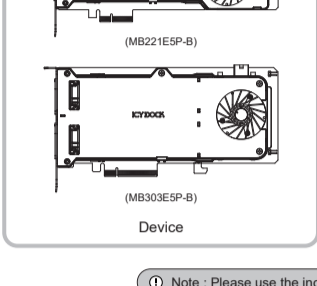

Note: Please use the included screws to secure the device.

2

Device Information • Geräteinformationen • Informations dispositif

• Información del dispositivo • 本体説明 • 機體説明 • 机体说明

MB221E5P-B

▼ Top View

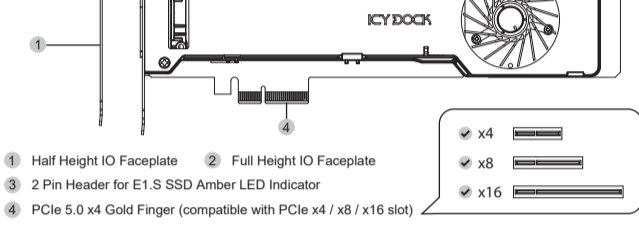

- 1 Half Height IO Faceplate
- 2 Full Height IO Faceplate
- 3 2 Pin Header for E1.S SSD Amber LED Indicator
- 4 PCIe 5.0 x4 Gold Finger (compatible with PCIe x4 / x8 / x16 slot)

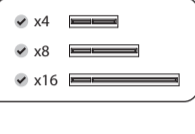

▼ Front View

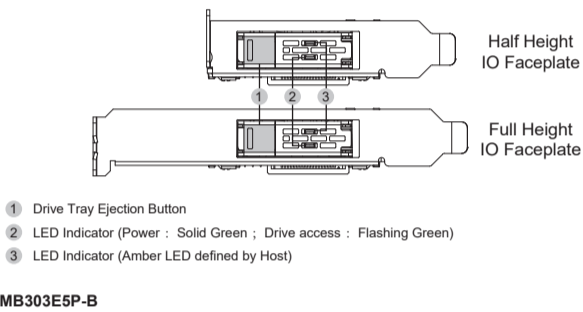

- 1 Drive Tray Ejection Button
- 2 LED Indicator (Power : Solid Green ; Drive access : Flashing Green)
- 3 LED Indicator (Amber LED defined by Host)

MB303E5P-B

▼ Top View

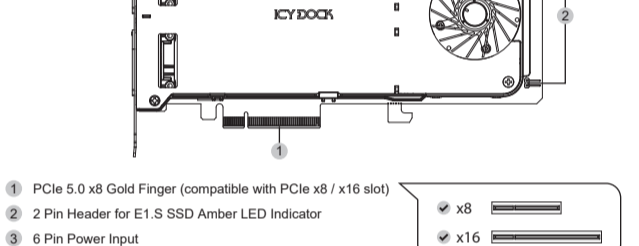

- 1 PCIe 5.0 x8 Gold Finger (compatible with PCIe x8 / x16 slot)
- 2 2 Pin Header for E1.S SSD Amber LED Indicator
- 3 6 Pin Power Input

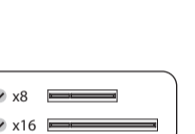

▼ Front View

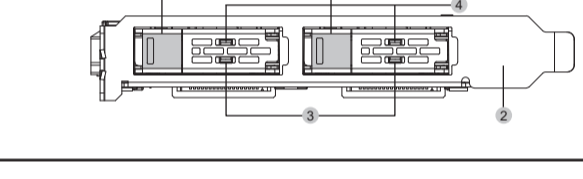

- 1 Drive Tray Ejection Button
- 2 Full Height IO Faceplate
- 3 LED Indicator (Power : Solid Green ; Drive access : Flashing Green)
- 4 LED Indicator (Amber LED defined by Host)

MB221E5P-B & MB303E5P-B

▼ Drive Tray Inner View

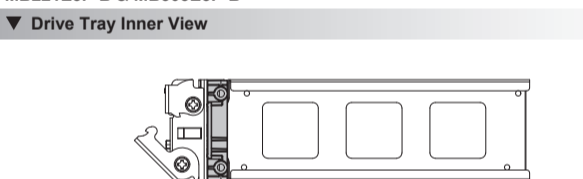

E1.S SSD Locker

3

Installation Guide • Installationsanleitung • Guide d'Installation • Guía de instalación • 製品の組み込み手順について • 操作步驟 • 操作步驟

3-1

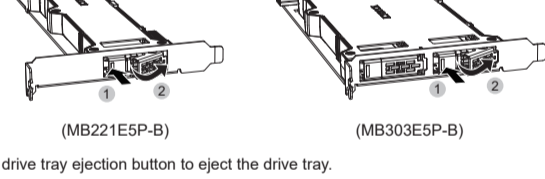

Push the drive tray ejection button to eject the drive tray.

3-2

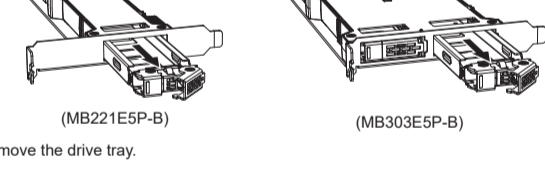

Pull to remove the drive tray.

▼ Install the E1.S SSD

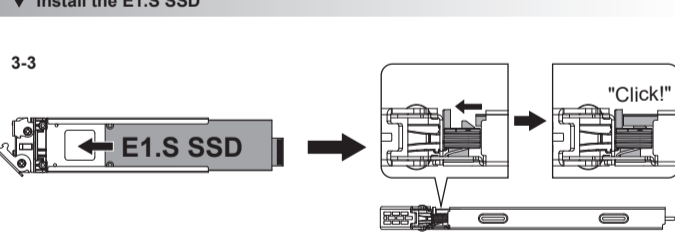

To install the E1.S SSD, slide the SSD horizontally until you hear a distinct "click" sound. This click indicates that the latch has securely engaged with the tray's groove, ensuring that the drive tray is firmly locked in place.

▼ Remove the E1.S SSD

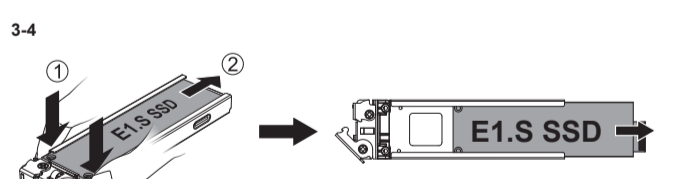

To remove the E1.S SSD, press the latch downwards and once fully depressed, pull out the E1.S SSD.

3-5

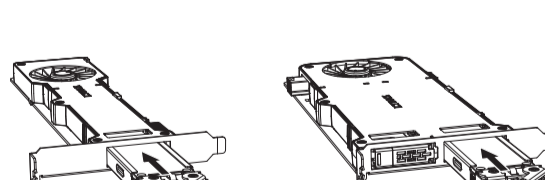

(MB221E5P-B) (MB303E5P-B)

4

Device Installation • Installation eines Gerätes • Installation du dispositif

• Instalación del dispositivo • デバイス取付手順 • 装置安裝步驟 • 设备安裝步驟

MB221E5P-B

MB303E5P-B

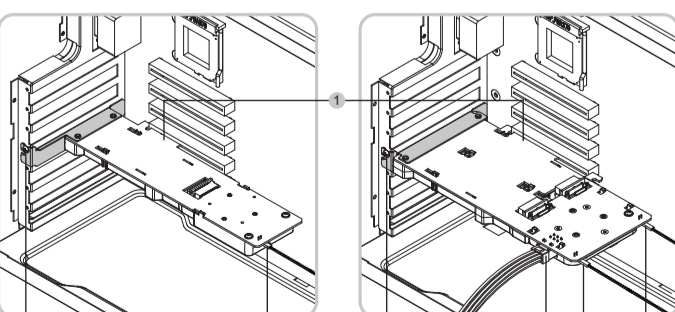

- 1 Fully connect the device's PCIe golden finger into the system's PCIe slot.
- 2 Use the included #6-32*6 screw to secure the device.
- 3 (optional) Connect the 2 pin header to the system's LED light signal cable to drive the E1.S SSD amber LED indicator
- 4 For the MB303E5P-B model only, ensure to connect the 6-pin power connector from the power supply to the 6-pin power input for sufficient power supply.

Warranty

icydock.com/warranty



Check coverage and terms

Product Resources

Specs · Data Sheet · FAQ



MB221E5P-B



MB303E5P-B

ICY DOCK reserves the right to change product specifications, components, or accessories without prior notice